

Powering the C3T On and Off

Powering On the C3T

Compact Device

Press the green **[On/Off]** key on the monitoring unit.
All modules will be powered on.

By pressing the **AED** or **Manual** key on the monitoring unit the C3T will start up in AED mode or manual defibrillation mode respectively.



Modular Use

Press the green **[On/Off]** key on all individual modules. The modules will be powered on individually.



Semi-Modular Use

Press the green **[On/Off]** key on the monitoring unit. The monitoring unit and the mechanically connected module are powered on.

Press the green **[On/Off]** key on the separate module. This module will be powered on.

Connecting Modules

When a powered-off module is connected mechanically to a powered-on module, the module that was off, will power on automatically.

Powering Off the C3T

Compact Device

Press the green **[On/Off]** key on the monitoring unit. A prompt will appear on-screen. To ensure all mission files are uploaded (if this option is enabled and configured), press the **[OK]** softkey.



The following screen will be displayed. The device will power off automatically following mission upload.

 To ensure missions are automatically uploaded, **DO NOT** press the **[On/Off]** key, as shutting down the device at this stage will interrupt transmission.

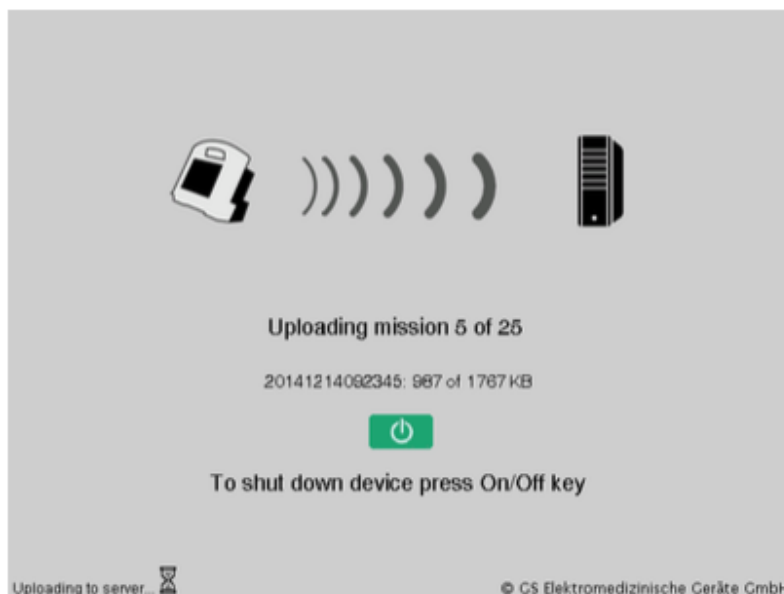

(Semi) Modular Use

Press the **[On/Off]** key on the monitoring unit.

All modules connected with the monitoring unit, either mechanically or by radio connection, are powered off when the softkey **[OK]** is pressed after the confirmation prompt appears.

Defibrillator and Patient Box

The defibrillator and patient box can be powered off independently, without influencing the remaining modules.

To power off, press the **[On/Off]** key on the respective module and hold for 3 seconds.

Powering Off in Pacer Mode

Press the green **[On/Off]** key. The following confirmation prompt will be displayed:

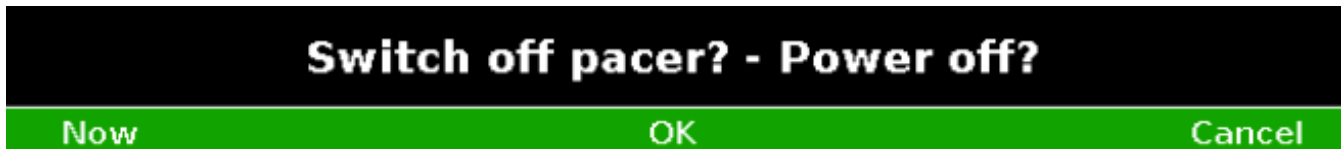

If the unit should be powered off, despite pacer mode being active, press the softkey **[OK]**.

If the unit should not be powered off at this time, press the softkey **[Cancel]**.

Cancelling Power-Off

The power-off process of the monitoring unit and connected modules can be cancelled by pressing the softkey **[Cancel]**.

If no action is taken within 10 seconds of the confirmation prompt appearing, the prompt automatically disappears, and the device remains on.

Powering Down in Case of System Crash

In case of a system crash of the compact device or an individual module, hold down the green **[On/Off]** key of the respective module for a minimum of 8 seconds, until the module powers off. It is not necessary to remove the battery.

Subsequently, the module can be restarted using the green **[On/Off]** key as usual.

Warnings when Powering Off

When powering off the monitoring unit, if no connection exists with the other modules or if a timing problem exists between modules, this is indicated to the user by the message **Check modules**.

Separate the modules to check if all modules have been powered down. If any modules remain on, use the green **[On/Off]** key to power off the module independently.
